

1-800-639-2199

Fax (603) 224-2927

Light Pole Bases\Piers\16 Inch Dia Pier with Footing (v)

Phoenix Precast Products

Phoenix Precast Products

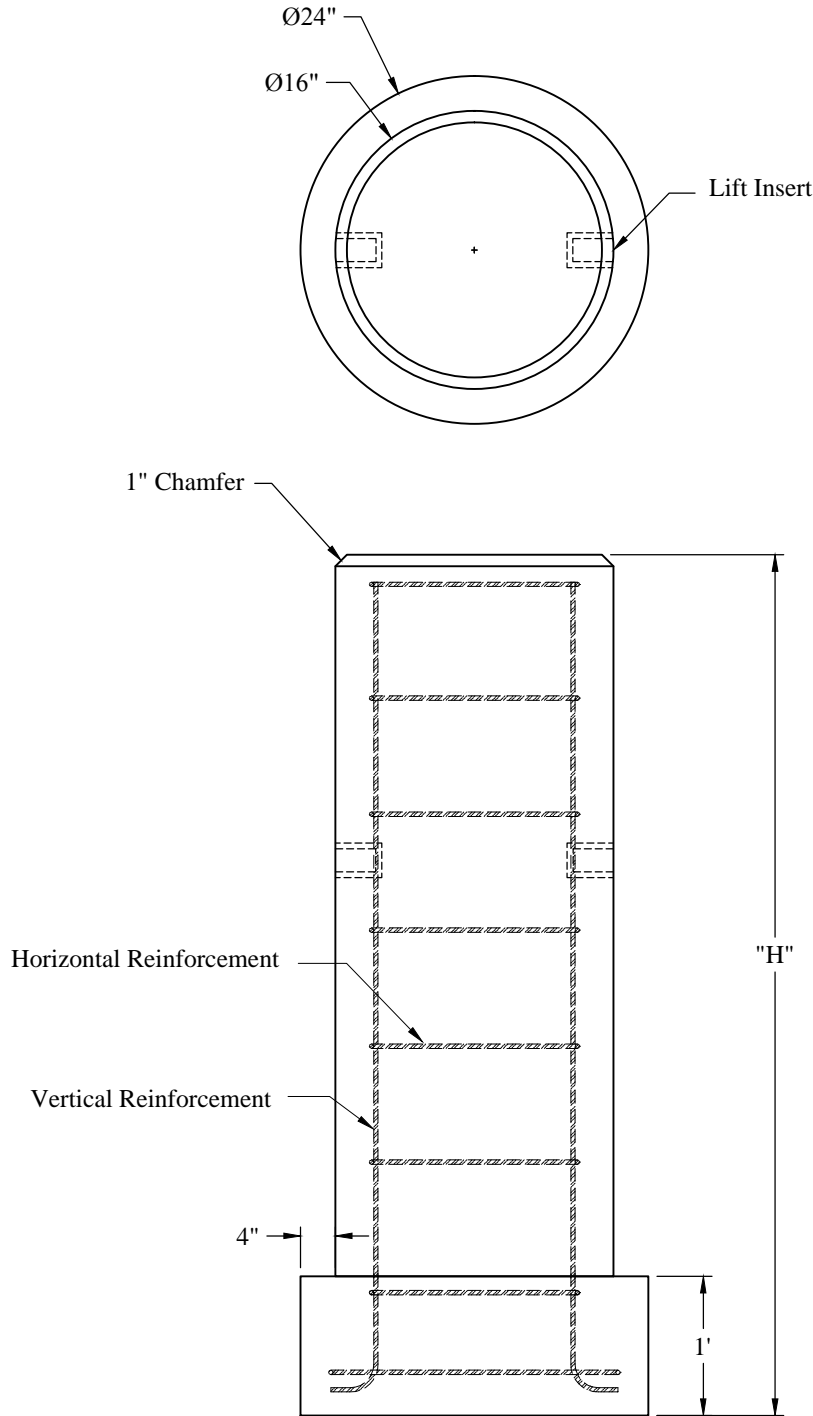

Height	Weight	P/N:
3'	885 lbs	PIER-16R3F
4'	1,095 lbs	PIER-16R4F
5'	1,300 lbs	PIER-16R5F
6'	1,510 lbs	PIER-16R6F
7'	1,720 lbs	PIER-16R7F

General Notes

1. Concrete: $f_c = 4,000$ PSI @ 28 Days Minimum
2. Reinforcing Steel Conforms to Latest ASTM Specifications:
ASTM A615 Grade 60 Rebar Black Deformed Bars

Phoenix
Precast
Products

16" Diameter Pier
With Footing